



MICRO COMPONENT SYSTEM

UX-G300

—Consists of CA-UXG300 and SP-UXG300



Thank you for purchasing a JVC product.

INSTRUCTIONS

GVT0241-015A[US/UN/UB/UG/A/UW]
0108WWMKMDJMM

©2008 Victor Company of Japan, Limited

IMPORTANT FOR LASER PRODUCTS

- CLASS 1 LASER PRODUCT
- CAUTION:** Do not open the top cover or cabinet. There are no user serviceable parts inside the unit; leave all servicing to qualified service personnel.
- CAUTION:** Visible and/or invisible class 1M laser radiation when open. Do not view directly with optical instruments.
- REPRODUCTION OF LABEL: CAUTION LABEL, PLACED INSIDE THE UNIT.

CAUTION VISIBLE AND/OR INVISIBLE CLASS 1M LASER RADIATION WHEN OPEN. DO NOT VIEW DIRECTLY WITH OPTICAL INSTRUMENTS. REPRODUCE THIS LABEL INSIDE THE UNIT.	ATTENTION VISIBLE AND/OR INVISIBLE CLASS 1M LASER RADIATION WHEN OPEN. DO NOT VIEW DIRECTLY WITH OPTICAL INSTRUMENTS. REPRODUCE THIS LABEL INSIDE THE UNIT.	AVISO VISIBLE Y/O INVISIBLE Y/O CLASE 1M RADIACION LASER AL ABRIR EL CUBIERTA. NO MIRE DIRECTAMENTE CON INSTRUMENTOS OPTICOS. REPRODUCA ESTA ETIQUETA DENTRO DEL APARATO.	WARNING VISIBLE AND/OR INVISIBLE CLASS 1M LASER RADIATION WHEN OPEN. DO NOT VIEW DIRECTLY WITH OPTICAL INSTRUMENTS. REPRODUCE THIS LABEL INSIDE THE UNIT.	注意 VISIBLE AND/OR INVISIBLE CLASS 1M LASER RADIATION WHEN OPEN. DO NOT VIEW DIRECTLY WITH OPTICAL INSTRUMENTS. REPRODUCE THIS LABEL INSIDE THE UNIT.	CAUTION VISIBLE AND/OR INVISIBLE CLASS 1M LASER RADIATION WHEN OPEN. DO NOT VIEW DIRECTLY WITH OPTICAL INSTRUMENTS. REPRODUCE THIS LABEL INSIDE THE UNIT.
---	---	---	---	--	---

Warnings, Cautions and Others

CAUTION: ϕ /I (Standby/on) button!

Disconnect the mains plug to shut the power off completely (the STANDBY lamp goes off). When installing the apparatus, ensure that the plug is easily accessible. The ϕ /I (Standby/on) button in any position does not disconnect the mains line.

- When the System is on standby, the STANDBY lamp lights red.
- When the System is turned on, the STANDBY lamp goes off.
- The power can be remote controlled.

CAUTION:

- To reduce the risk of electrical shocks, fire, etc.:

 - Do not remove screws, covers or cabinet.
 - Do not expose this appliance to rain or moisture.

CAUTION:

- Do not block the ventilation openings or holes. (If the ventilation openings or holes are blocked by a newspaper or cloth, etc., the heat may not be able to get out.)
- Do not place any naked flame sources, such as lighted candles, on the apparatus.
- When discarding batteries, environmental problems must be considered and local rules or laws governing the disposal of these batteries must be followed strictly.
- Do not expose this apparatus to rain, moisture, dripping or splashing and that no objects filled with liquids, such as vases, shall be placed on the apparatus.
- Excessive sound pressure from earphones or headphones can cause hearing loss.

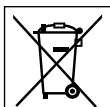

[European Union only]

CAUTION: Proper Ventilation

To avoid risk of electric shock and fire, and to prevent damage, locate the apparatus as follows:

- Front: No obstructions and open spacing.
- Sides/Top/Back: No obstructions should be placed in the areas shown by the dimensions below.
- Bottom: Place on the level surface. Maintain an adequate air path for ventilation by placing on a stand with a height of 10 cm or more.

Front view

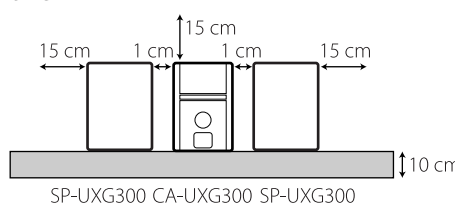

Side view

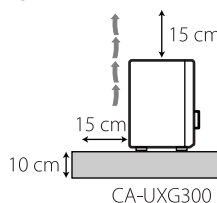

Precautions

Notes on the power cord

- When you are away on travel or otherwise for an extended period of time, remove the plug from the wall outlet.
- When unplugging the System from the wall outlet, always pull the plug, not the power cord.
- Do not handle the power cord with wet hands.
- Disconnect the power cord before cleaning the System or moving the System.
- Do not alter, twist or pull the power cord, or put anything heavy on it, which may cause fire, electric shock, or other accidents.
- If the cord is damaged, consult a dealer and have the power cord replaced with a new one.

Avoid moisture, water, dust, and high temperatures

- Do not place the System in moist or dusty places.
- If water gets inside the System, turn off the power and remove the plug from the wall outlet, then consult your dealer. Using the System in this state may cause a fire or electrical shock.
- Do not expose the System to direct sunlight or place it near a heating device.

Notes on installation

- Select a place which is level, dry and neither too hot nor too cold—between 5°C and 35°C.
- Do not install the System in a place subject to vibrations.
- Do not put heavy objects on the System.

To prevent malfunction or damage of the System

- Do not insert any metallic objects, such as wires, hairpins, coins, etc. into the System.
- Do not block the vents.

There are no user-serviceable parts inside. If anything goes wrong, unplug the power cord and consult your dealer.

Basic and Common Operations

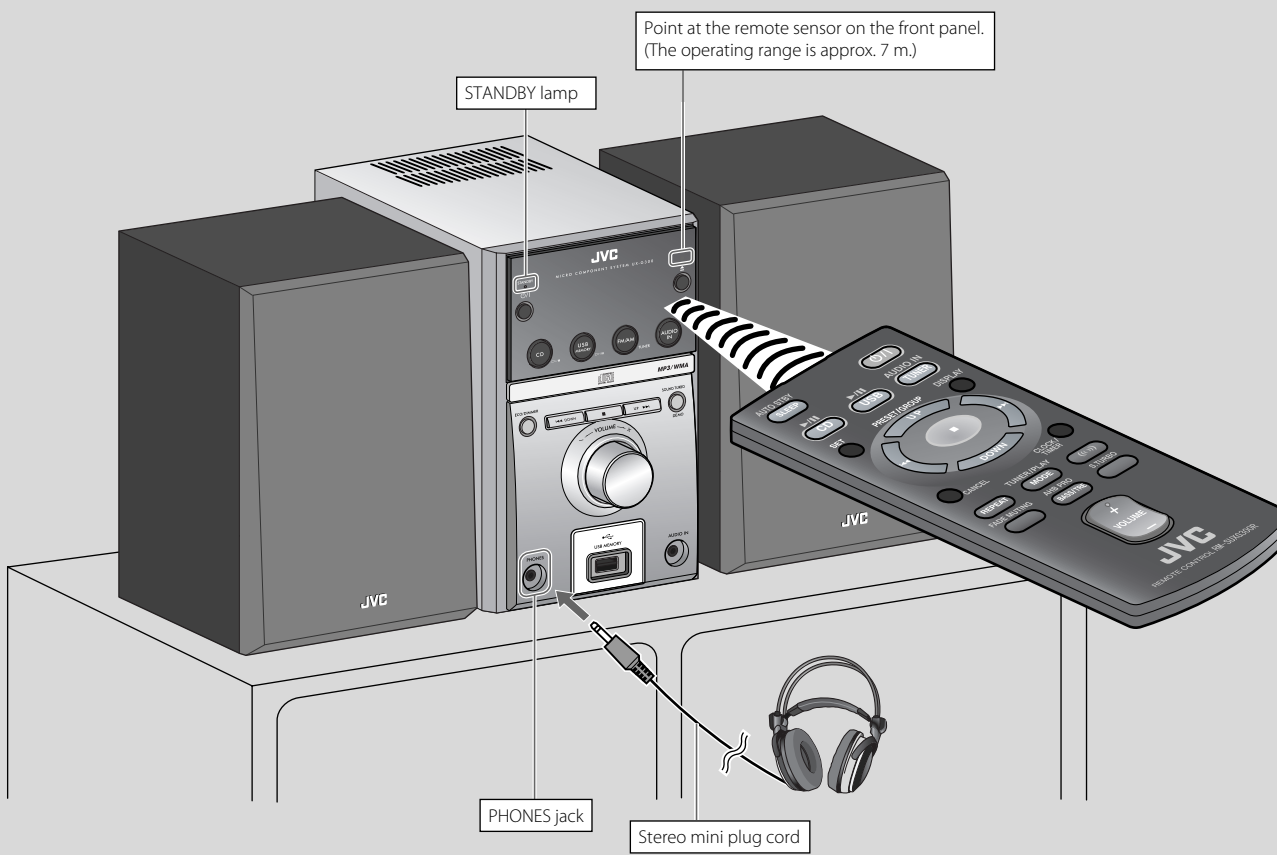

How to cancel the demonstration

Press and hold DEMO button while on standby. (Refer to the attached "Information about the demonstration function.")

Using Headphones

Be sure to turn down the volume before connecting or putting on the headphones.

- Connecting the headphones will deactivate the speakers.
- Sound adjustments also affect the sound through the headphones.

NOTE:

DO NOT turn off (standby) the System with the volume set to an extremely high level; otherwise, the sudden blast of sound can damage your hearing, speakers and/or headphones when you turn on the System or start playback.

To	Press		Indication/Result
	System	Remote	
Turn on or off (standby) the power	ϕ /I	ϕ /I	The STANDBY lamp on the System turns off/on.
Select a source	CD, MP3, WMA	▶/II, CD, USB	See "Playing Back a Disc/USB Mass Storage Class Device" on page 4.
Adjust the volume	VOLUME	VOLUME	Adjustable range: Level 0 ("VOL MIN") to level 40 ("VOL MAX").
Drop the volume in a moment	—	FADE MUTING	To restore the volume, press again, or adjust the volume level.
Activate the EALA surround mode	—	0/0	The $\left(\left(\right)\right)$ indicator lights up. To cancel this function, press repeatedly until $\left(\left(\right)\right)$ indicator lights off.
Emphasize the sound (Sound Turbo function)	SOUND TURBO	S.TURBO	The S.TURBO indicator lights up. To cancel this function, press again.
Reinforce the bass sound (Active Hyper Bass Pro function)	—	AHB PRO	Press and hold until the AHB indicator lights up. When Sound Turbo function is activated (see above), this function cannot be activated. To cancel this function, press and hold again when Sound Turbo function is deactivated.
Adjust the tone (Bass/Treble)	—	AHB PRO, BASS, TREBLE	Press once for adjusting the bass level; twice for treble level, then, press VOLUME +/-.
Change the display brightness	ECONOMIZER	—	Press when the System is turned on. To cancel this function, press again.
Change the display information (Clock and Source)	—	DISPLAY	For setting the clock, see "Setting the Clock and Using Timers" on page 6.
Set the Save Mode	ECONOMIZER	—	Press when the System is on standby. Setting the save mode allows you to reduce power consumption by turning the display off while on standby. To cancel this function, press again when the System is on standby.

Getting Started

Supplied Accessories

After unpacking, check to be sure that you have all the following items.

- Remote control, RM-SUXG300U (x 1)
 - Lithium coin battery CR2025 (x 1)
 - The battery has been installed when shipped from the factory.
 - AM loop antenna (x 1)
 - FM antenna (x 1)
 - AC plug adapter (x 1) (not applicable for Hong Kong and Australia)
- If anything is missing, consult your dealer immediately.

Prepare the Remote Control

When you use the remote control for the first time, pull out the insulation sheet.

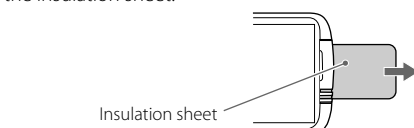

To Replace the Battery in the Remote Control

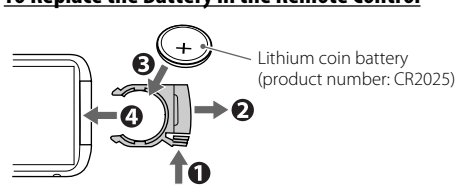

NOTES:

- Store the battery in a place where children cannot reach. If a child accidentally swallows the battery, consult a doctor immediately.
- To prevent the battery from over-heating, cracking, or starting a fire:
 - Do not recharge, short, disassemble or heat the battery or dispose of it in a fire.
 - Do not leave the battery with other metallic materials.
 - Wrap the battery with tape and insulate when throwing away or saving it.
 - Do not poke the battery with tweezers or similar tools.
- Dispose of battery in the proper manner, according to federal, state, and local regulations.
- The batteries (battery pack or batteries installed) shall not be exposed to excessive heat source such as sunshine, fire or the like.

CAUTION: Danger of explosion if battery is incorrectly replaced. Replace only with the same or equivalent type.

Connections

Do not connect the AC power cord until all other connections have been made.

To connect the FM antenna (supplied)

Extend it so that you can obtain the best reception.

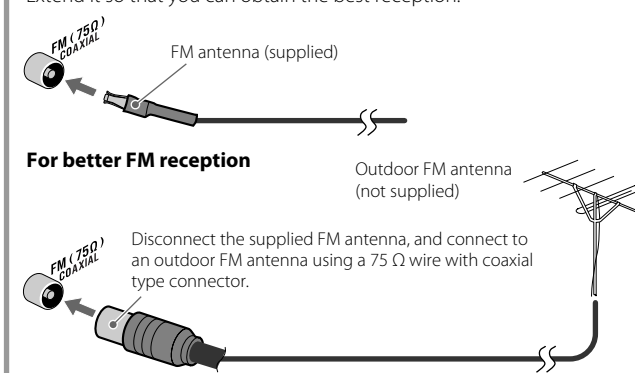

Rear view

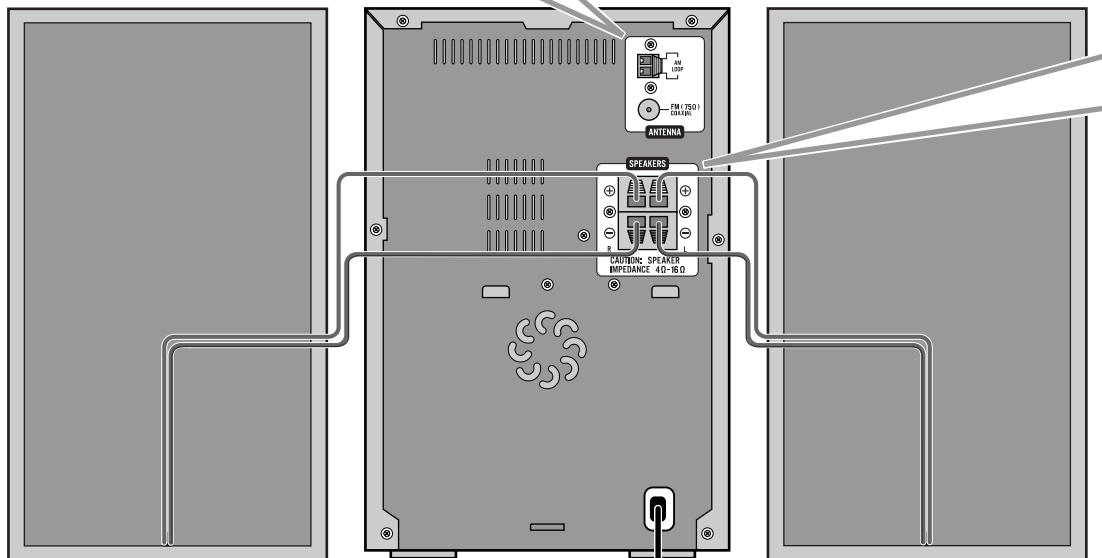

To a wall outlet
Plug the AC power cord only after all connections are complete.

- If the wall outlet does not match the AC plug, use the supplied AC plug adapter (not applicable for Hong Kong and Australia).

NOTES:

- Make sure the antenna conductors do not touch any other terminals, connecting cords and power cord. Also, keep the antennas away from metallic parts of the System, connecting cords, and the AC power cord. This could cause poor reception.
- Make sure both the speakers are connected correctly and firmly.
- When connecting the speaker cords, match the polarity of the speaker terminals: red color to (+) and black color to (-).
- DO NOT connect more than one speaker to each terminal.
- DO NOT allow the conductor of the speaker cords to be in touch with the metallic parts of the System.

To connect the AM loop antenna (supplied)

Turn it until the best reception is obtained.

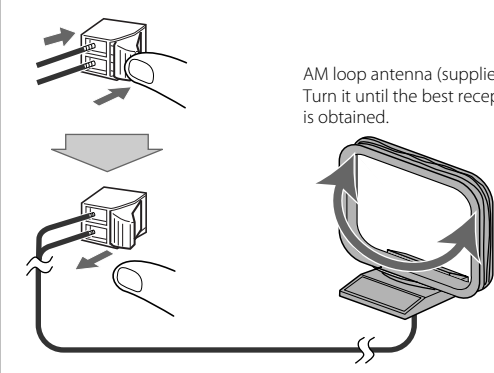

To assemble the AM loop antenna

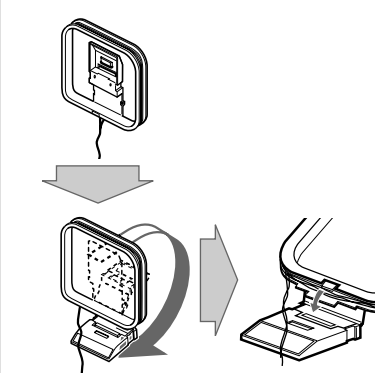

To connect the speaker cords

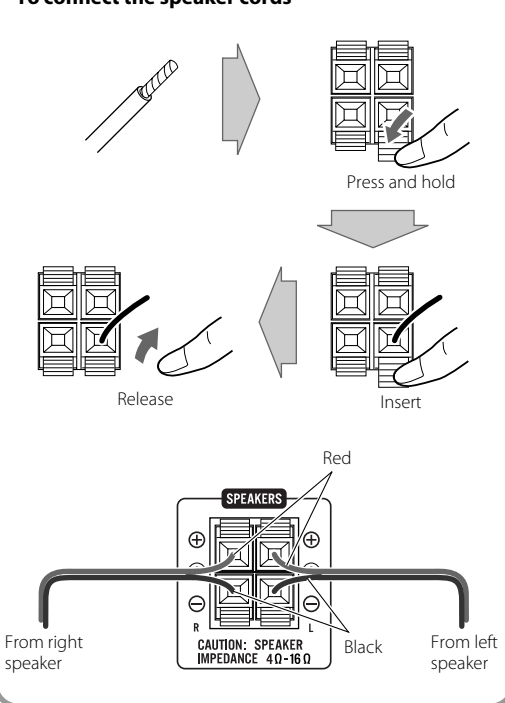

Playing Back a Disc/USB Mass Storage Class Device

The following operations are explained using the remote control, unless mentioned otherwise. However, if the System has the same or similar button names, they can also be used for the operations.

This System can play back...
- CD.
- CD-R/CD-RW recorded in audio CD format (CD-DA) or recorded MP3/WMA files in ISO 9660 format.
- USB mass storage class device containing MP3/WMA files.
- When playing back an MP3 or WMA track, MP3 or WMA indicator lights up.

Loading a Disc (on the System only)

- Press to open the disc tray.
- When using an 8 cm disc, place it on the inner circle of the disc tray.
- Press to close the disc tray.

Connecting a USB Mass Storage Class Device

You can connect a USB mass storage class device such as a USB flash memory device, MP3 player, multimedia card reader, etc. to the System.

Front view

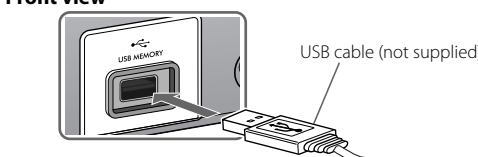

NOTES:

- When connecting with a USB cable, use the USB 2.0 cable whose length is less than 1 m.
- USB mass storage class device is charged through the USB MEMORY terminal when the System is turned on and the source is "USB."
- You cannot connect a computer to the USB MEMORY terminal of the System.
- Do not disconnect the USB mass storage class device when the System is turned on. It may cause malfunction of both this System and the device.
- Noise and static electricity may stop the USB mass storage class device sound. In this case, disconnect and connect the USB mass storage class device again after turning off the System.

Prohibiting Disc Ejection (on the System only)

You can lock the disc tray so that no one can eject the loaded disc.

- This is possible while the System is on standby.

To cancel the prohibition, repeat the same procedure.

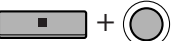

Basic Disc/USB Mass Storage Class Device Operations

To	Press	Indication/Result
Play back the disc	▶/II, CD	Current track number and elapsed playing time appear.
Play back the USB mass storage class device	▶/II, USB	For MP3/WMA files: Before current track number and elapsed playing time appear, the tag information appears if it is recorded. During playback, press again to pause.
Stop playback	■	While playback is stopped, total track number and total playing time (for MP3/WMA files, group number and track number) appear.
Select a track	▶/II, ◀, ▶	Select the next tracks.
Select a group (MP3/WMA only)	PRESET GROUP UP, DOWN	Select the next groups. Select the previous groups.
Forward search/Reverse search	▶/II, ◀, ▶	Press and hold to fast-forward the track during playback. To stop searching, release the button. Press and hold to fast-reverse the track during playback. To stop searching, release the button.

NOTES:

- If no disc is inserted or no USB mass storage class device is connected, "NO DISC" or "NO USB" appears on the main display.
- If MP3/WMA files are not recorded on the disc or in the USB mass storage class device, "NO PLAY" appears on the main display.

RESUME Play (For MP3/WMA only)

When you stop the playback by one of the following operations, this System stores the beginning of the stopped track on the disc or USB mass storage class device.

- Pressing ■ once
- Changing the source

When you start playback again, playback starts from the stored position. To clear the stored position, open the disc tray or disconnect the USB mass storage class device. When you clear the stored position and start playback, playback starts from the beginning of the first track.

NOTE:

This function does not work in Program Play and Random Play.

Playing Repeatedly—Repeat Play

- Press repeatedly to specify the repeat mode as follows:
 - REP TRK: Repeats the current (or specified) track. [◀] 1
 - REP GRP: Repeats all tracks in the current group (MP3/WMA only). [◀] 2
 - REP ALL: Repeats all tracks. [◀] ALL
 - REP OFF: Normal playback
- Press ▶/II, CD or USB

Programming the Playing Order—Program Play

- During stops, press until the PRGM (program) indicator lights up before playing.
- For MP3/WMA files: Select a group number, then a track number.
- For CD: Select a track number.
- Press to program the selected group/track.
- Repeat steps 2 and 3 to program other tracks you want.
 - If you try to program a 51st track, "FULL" will appear.
- The tracks are played back in the programmed order.

Operations for Program Play (while not playing)

- To check the programmed contents, press ◀▶.
- To add tracks, repeat steps 2 and 3 above.
- To erase the last programmed track, press CANCEL.
- To erase the entire program, press and hold CANCEL for about 2 seconds.
- To exit from program play, press MODE.
 - The stored program is kept.

Playing at Random—Random Play

- Press until the RND (random) indicator lights up before you start playback.
- Press ▶/II, CD or USB. Playback starts in random order. Random Play ends when all tracks are played back.

Operations for Random Play

- To skip a track, press ▶▶.
- To go back to the beginning of the current track, press ◀◀.
- To exit from random play, press MODE while playback is stopped.

Listening to FM and AM Broadcasts

The following operations are explained using the remote control, unless mentioned otherwise. However, if the System has the same or similar button names, they can also be used for the operations.

Basic Tuner Operations

To	Press	Indication/Result
Set the AM tuner intervals to 9 kHz spacing		On the System only: Press and hold DOWN , then press FM/AM when the System is on standby.
Set the AM tuner intervals to 10 kHz spacing		On the System only: Press and hold UP , then press FM/AM when the System is on standby.
Select FM or AM		Press repeatedly. • The selected frequency band appear.
Select a frequency		Press and hold for more than 2 seconds. The System starts searching for stations and stops when a station of sufficient signal strength is tuned in. • If an FM program is broadcast in stereo, the S (stereo) indicator lights up (only when the reception is good). • Press during searching to stop. • Press repeatedly to change the frequency step by step.
Tune in to a preset station		Press to select its preset number. • For presetting stations, see below.
Change the FM reception mode (When an FM stereo broadcast is hard to receive)		Press to improve reception. The M (mono) indicator lights up. Stereo effect will be lost. To restore the stereo effect , press again.

Presetting Stations

You can preset 30 FM and 15 AM stations manually.

- Tune in to a station you want to preset.
 - You can also store the FM reception mode.
- Press to activate the preset number entry mode.
 - Finish the following steps while the indication on the display is flashing.
- Press to select a preset number for the station you want to store.
- Press to store the station.

Listening to Digital Audio Player

The following operations are explained using the remote control, unless mentioned otherwise. However, if the System has the same or similar button names, they can also be used for the operations.

Listening to Digital Audio Player

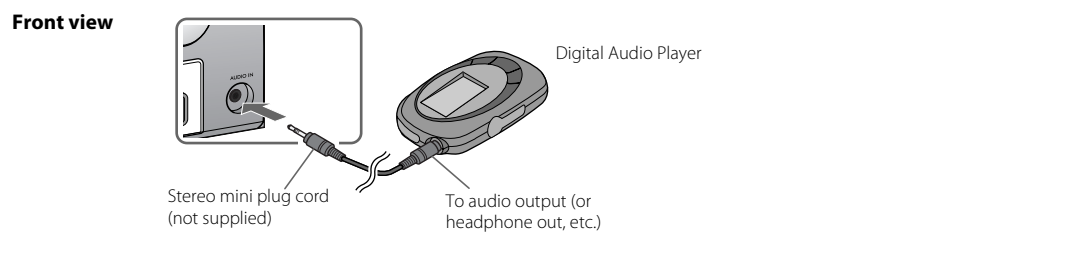

- Turn the volume to minimum.
- Press repeatedly to select "AUDIO IN."
- Start playing the Digital Audio Player connected.
- Adjust the volume.

To Adjust the Audio Input Level

If the sound from the Digital Audio Player connected to the AUDIO IN jack is too loud or too quiet, you can change the audio input level through the AUDIO IN jack (without changing the volume level).

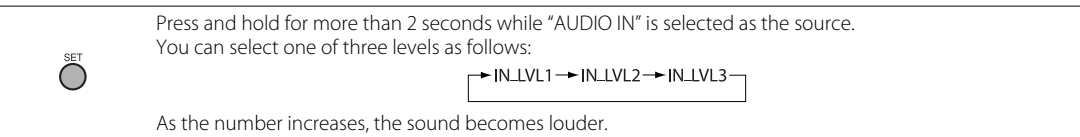

Learning More about This System

Basic and Common Operations (see page 3)

- Pressing one of the source buttons also turns on the System and starts playing back if the source is ready or connected.

Playing Back a Disc/USB Mass Storage Class Device (see page 4)

- This System cannot play "packet write" discs.
- For MP3/WMA playback.
 - In this manual, "file" and "track" are interchangeably used for MP3/WMA operations.
 - This System can show the Tag data (Version 1).
 - MP3/WMA discs are required a longer readout time than regular CDs. (It depends on the complexity of the group/file configuration.)
 - Some MP3/WMA files cannot be played back and will be skipped. This result from their recording processes and conditions.
 - When making MP3/WMA discs, use ISO 9660 Level 1 or Level 2 for the disc format.
 - This System can play back MP3/WMA files with the extension code <mp3> or <.wma> (regardless of the letter case—upper/lower).
 - It is recommended that you make each MP3/WMA file at a sampling rate of 44.1 kHz and at bit rate of 128 kbps. This System cannot play back files made at bit rate of less than 64 kbps.
 - Playback order of MP3/WMA tracks may be different from the one you have intended while recording. If a folder does not include MP3/WMA tracks, they are ignored.
- Do not use the following USB devices.
 - Whose rating is other than 5 V and exceeds 500 mA.
 - Equipped with special functions such as data security functions.
 - Divided by 2 or more partitions.
- For the USB mass storage class device playback...
 - When connecting a USB mass storage class device, also refer to its manual.
 - Connect one USB mass storage class device to the System at a time. Do not use a USB hub.
 - This System is compatible with USB 2.0 Full Speed.
 - You can play back MP3/WMA files in a USB mass storage class device (maximum data transfer rate: 2 Mbps).
 - You cannot play back a file larger than 2 Gigabyte.
 - This System may not play back some USB mass storage class devices and does not support DRM (Digital Rights Management).

- This System can recognize up to 99 groups in a disc. The total number of groups and tracks (in a disc) that can be recognized by the System is 512 (for MP3/WMA).
- This System can recognize up to 99 groups and 9 999 tracks (with a maximum number of 255 tracks in a group) in a USB mass storage class device.

Setting the Clock and Using Timers (see page 6)

- You can set the clock and Daily Timer while the Save Mode is turned on. While setting the clock or Daily Timer, the display is turning on.
- The clock may gain or lose 1 to 2 minutes per month. If this happens, readjust the clock.
- When you unplug the AC power cord or if a power failure occurs, the clock and the timer will be canceled. You need to set the clock first, then the timer again.

Timer Priority:

- If you set the Sleep Timer after Daily Timer starts playing the selected source, Daily Timer is canceled.

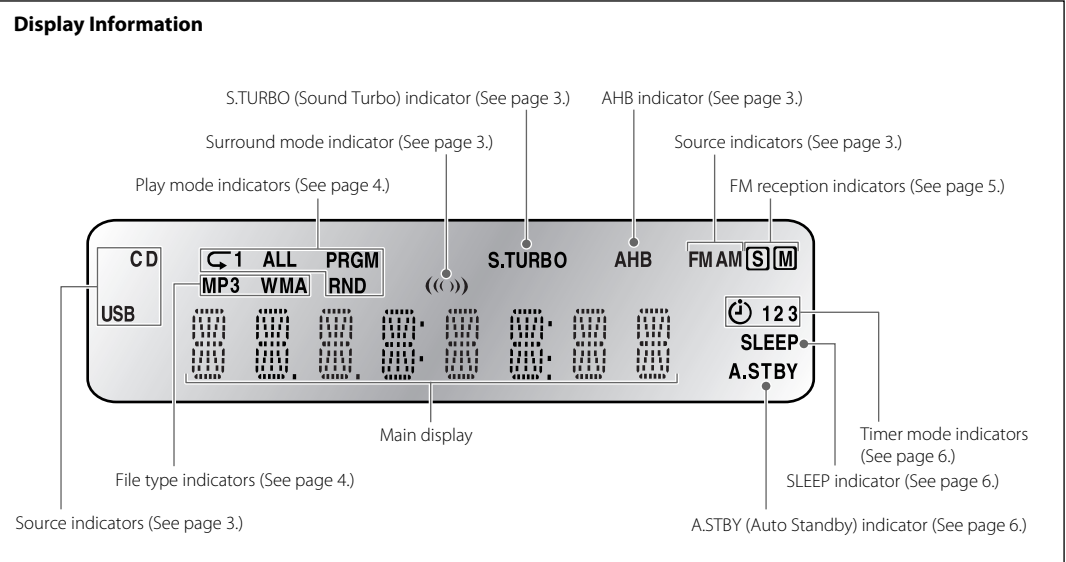

Setting the Clock and Using Timers

The following operations are explained using the remote control, unless mentioned otherwise. However, if the System has the same or similar button names, they can also be used for the operations.

Setting the Clock

Without setting the built-in clock, you cannot use Daily Timer and Sleep Timer.

- "0:00" flashes on the main display until you set the clock.
- Press to activate the clock setting mode.
 - If you have already adjusted the clock before, press the button repeatedly until the clock setting mode is selected.
 - Adjust the hour, then the minute.

- To exit from the clock setting, press CLOCK/TIMER as required.
- To go back to the previous step, press CANCEL.

Setting the Sleep Timer

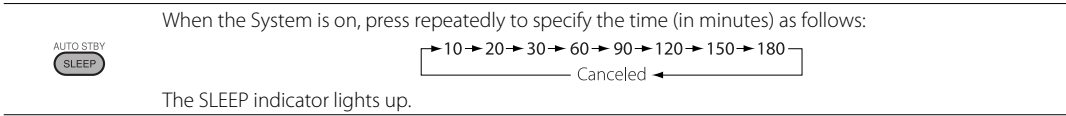

- To check the remaining time until the System shuts off, press once.

Turning Off the System Automatically

—AUTO STANDBY function (only for Disc/USB)

- Press and hold until the A.STBY indicator lights on the display.
- The A.STBY indicator starts flashing after playback stops.
 - If no operation is done for about 3 minutes, the System turns off.
 - Not applicable for FM/AM/AUDIO IN.

To cancel this function, press and hold again.

Setting the Daily Timer

Using Daily Timer, you can wake up with your favorite music.

- You can store three Daily Timer settings; however, you can activate only one of the Daily Timers.

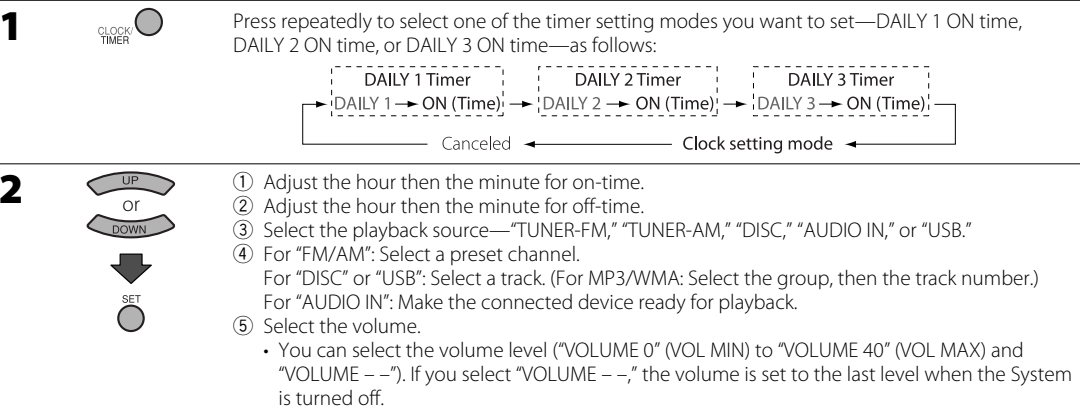

- Turn off the System (on standby).
 - When the on-time comes, the System sets the volume gradually to the preset level.

- To exit from the timer setting, press CLOCK/TIMER as required.
- To correct a misentry during the process, press CANCEL. You can return to the previous step.

To Turn Off the Daily Timer

- Press repeatedly to select "DAILY 1," "DAILY 2," or "DAILY 3."



To turn on the Daily Timer again, select one of the timer settings by pressing CLOCK/TIMER, then press SET.

Troubleshooting

If you are having a problem with your System, check this list for a possible solution before calling for service.

General

Power does not come on.

- Power plug is not inserted securely. Plug in securely.

Adjustments or settings are suddenly canceled before you finish.

- There is a time limit. Repeat the procedure again.

Operations are disabled.

- The built-in microprocessor may malfunction due to external electrical interference. Unplug the AC power cord and then plug it back in.

Unable to operate the System from the remote control.

- The path between the remote control and the remote sensor on the System is blocked.
- The batteries are exhausted.

No sound is heard.

- Speaker connections are incorrect or loose.
- Headphones are connected.

The System does not work properly.

- Many functions of this System are implemented by microcomputers. If the System does not work correctly, disconnect the AC power cord from the wall outlet, wait for a while, and connect the cord again.

Disc/USB Mass Storage Class Device Operations

The disc/USB mass storage class device does not play.

- The disc is placed upside down. Place the disc with the label side up.
- The disc is recorded with the "packet writing (UDF file system)." It cannot be played. Check the files you want to play back.
- The USB mass storage class device is not connected properly.

MP3/WMA groups and tracks are not played back as you expect.

- Playing order is determined when the groups and tracks were recorded. It depends on the writing application.

The disc/USB mass storage class device sound is discontinuous.

- The disc is scratched or dirty.
- MP3/WMA files have not been properly copied into the USB mass storage class device.

Sounds from USB mass storage class device are interrupted.

- Noise and static electricity may stop the sound. In this case, disconnect and connect the USB mass storage class device again after turning off the System.

The disc tray does not open or close.

- The AC power cord is not plugged in.
- Disc ejection is prohibited (see page 4).

Radio Operations

Hard to listen to broadcasts because of noise.

- Antennas connections are incorrect or loose.
- The AM loop antenna is too close to the System.
- The FM antenna is not properly extended and positioned.
- Electrostatic discharge from your body may cause noise. If this happens, turn off and on the System again.

Timer Operations

Daily Timer does not work.

- The System has been turned on when the on-time comes. Timer starts working only when the System is turned off.

Maintenance

To get the best performance of the System, keep your discs and mechanism clean.

Handling discs

- Remove the disc from its case by holding it at the edge while pressing the center hole lightly.
- Do not touch the shiny surface of the disc, or bend the disc.
- Put the disc back in its case after use.
- Be careful not to scratch the surface of the disc when placing it back in its case.
- Avoid exposure to direct sunlight, temperature extremes, and moisture.

To clean the disc:

- Wipe the disc with a soft cloth in a straight line from center to edge.

Cleaning the System

- Stains should be wiped off with a soft cloth. If the System is heavily stained, wipe it with a cloth soaked in water-diluted neutral detergent and wrung well, then wipe clean with a dry cloth.
- Since the System may deteriorate in quality, become damaged or get its paint peeled off, be careful about the following:
 - DO NOT wipe it hard.
 - DO NOT wipe it with thinner or benzine.
 - DO NOT apply any volatile substance such as insecticides to it.
 - DO NOT allow any rubber or plastic to remain in contact for a long time.

JVC bears no responsibility for any loss of data in USB mass storage class device while using this System.

Microsoft and Windows Media are either registered trademarks or trademarks of Microsoft Corporation in the United States and/or other countries.

Specifications

Amplifier section

OUTPUT POWER: 60 W (30 W + 30 W) at 4 Ω (10% THD)
Speakers/Impedance: 4 Ω – 16 Ω
Audio input: AUDIO IN: 500 mV/47 kΩ (at "IN LVL1")
 250 mV/47 kΩ (at "IN LVL2")
 125 mV/47 kΩ (at "IN LVL3")
 USB MEMORY

Digital input:

Tuner section

FM tuning range: 87.50 MHz - 108.00 MHz
AM tuning range: 530 kHz - 1 710 kHz (in 10 kHz spacing)
 531 kHz - 1 710 kHz (in 9 kHz spacing)

CD player section

Dynamic range: 88 dB
Signal-to-noise ratio: 85 dB
Wow and flutter: Immeasurable

USB storage

USB specification: Compatible with USB 2.0 Full Speed
Compatible device: Mass storage class
Compatible file system: FAT16, FAT32
Bus power supply: Max. 500 mA

Speakers

Speaker units: 10 cm cone x 1
Impedance: 4 Ω
Dimensions (approx.): 160 mm x 250 mm x 150 mm (W/H/D)
Mass (approx.): 1.6 kg each

General

Power requirements: AC 110 V - AC 240 V ~, 50/60 Hz
 AC 240 V ~, 50 Hz (only Australia)
 AC 220 V ~, 50 Hz (only Hong Kong)

Power supply to USB mass storage class device:

DC 5 V ± 500 mA
 20 W (power on)
 6.5 W (standby mode)

Power consumption: 1 W or less (Save Mode)
Dimensions (W x H x D): 165 mm x 251 mm x 269 mm
Mass: 2.6 kg

Specifications and appearance are subject to change without prior notice.